

CAPSULE SLIP RINGS

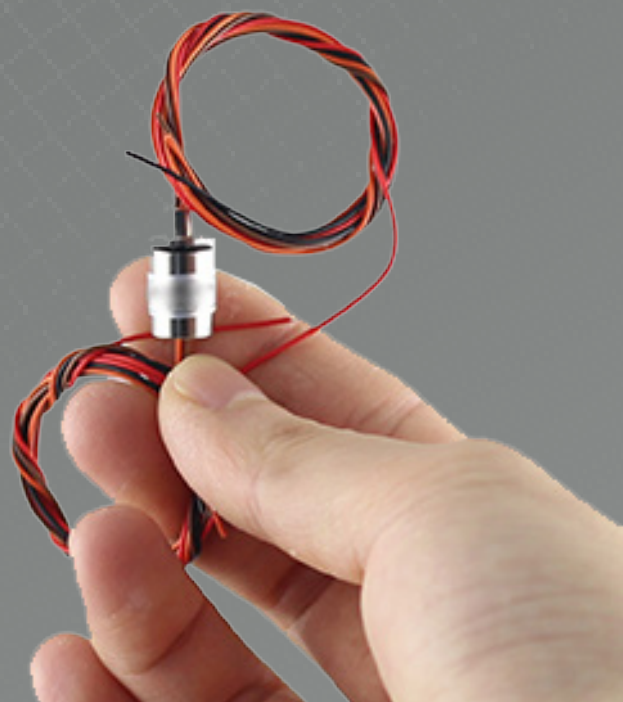
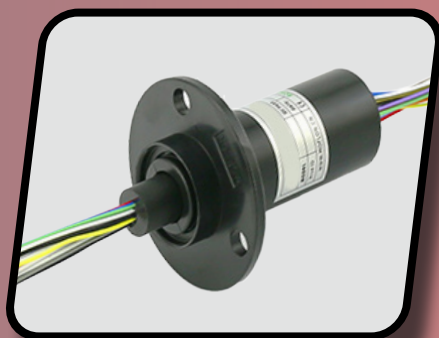
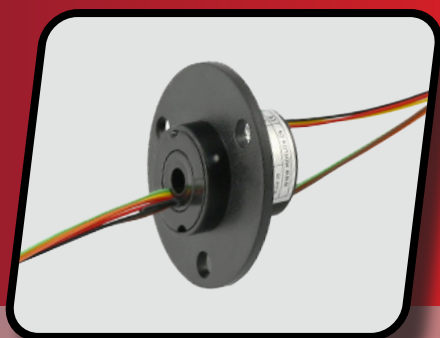

CTC SERIES

V2.2.12

DRAWINGS

CTC005S-00P/XS

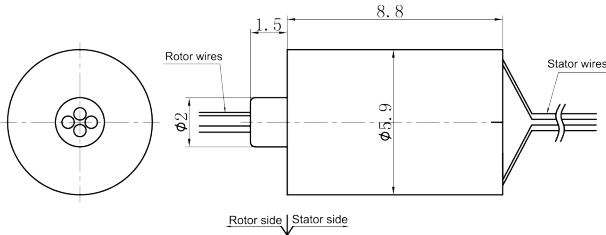

CTC005S-00P/XS
CTC006S-00P/XS

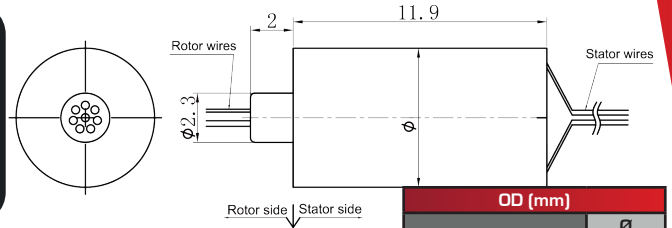

OD (mm)	
	Ø
CTC005S-00P/02S	5,9
CTC006S-00P/04S	6,5

CTC011S-00P/XS

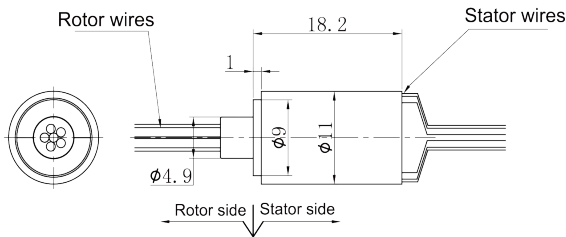

CTC012S-00P/XS

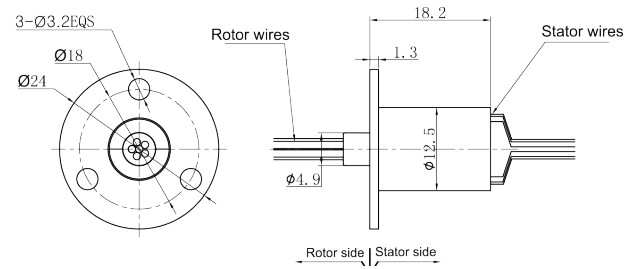

CTC012S-00P/XS

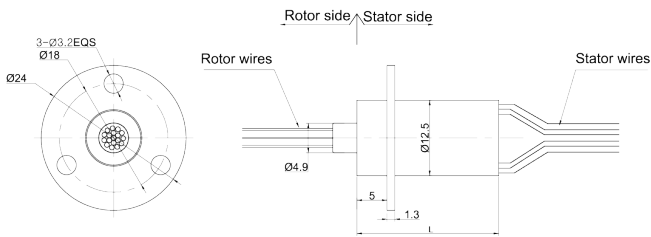

LENGTH (mm)	
	L
CTC012S-00P/12S	19,5
CTC012S-00P/18S	23,5

CTC015S-00P/XS

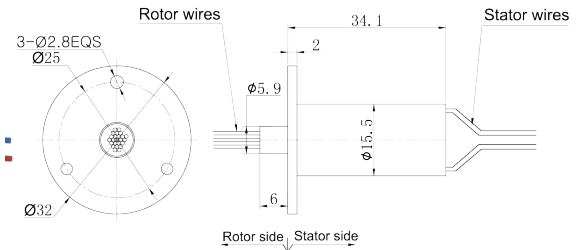

CTC022S-00P/XS

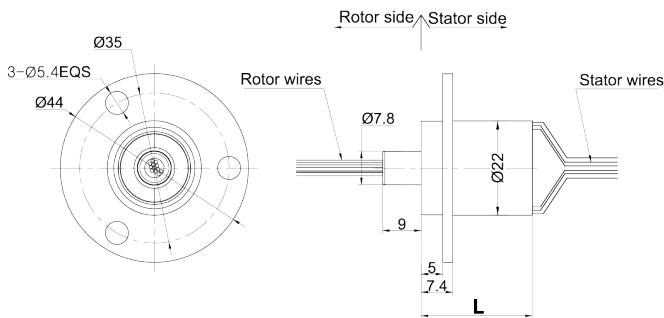

LENGTH (mm)	
	L
CTC022S-00P/06S	19
CTC022S-00P/12S	26
CTC022S-00P/18S	33
CTC022S-00P/36S	57,3

CTC022S-00P/XS

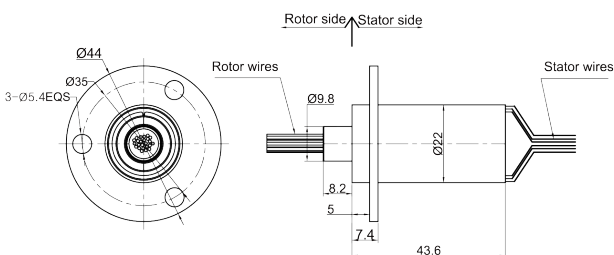

CTC025S-00P/XS

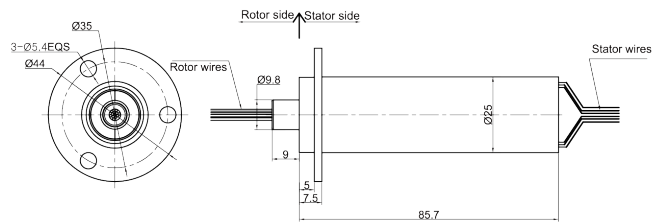

TECHNICAL DATA

Model	Length	OD	Circuits						Total Wires	Max Working speed (rpm)		Working life (cycles)		Electrical Noise @10rpm (mΩ)		Housing material	
			Signal					S		I	S	I	S	I	S	I	
			1A	2A	4A	8A	15A										
CTC005	CTC005S-00P/02S	8,8	5,9	2	-	-	-	-	2	250	1000	1e ⁰⁷	3e ⁰⁷	10	4	ABS	ABS
	CTC005S-00P/04S	8,8	5,9	4	-	-	-	-	4	250	1000	1e ⁰⁷	3e ⁰⁷	10	4	ABS	ABS
	CTC005S-00P/02S	11,9	5,9	2	-	-	-	-	2	250	1000	1e ⁰⁷	3e ⁰⁷	10	4	ABS	ABS
	CTC005S-00P/04S	11,9	5,9	4	-	-	-	-	4	250	1000	1e ⁰⁷	3e ⁰⁷	10	4	ABS	ABS
	CTC005S-00P/06S	11,9	5,9	6	-	-	-	-	6	250	1000	1e ⁰⁷	3e ⁰⁷	10	4	ABS	ABS
	CTC005S-00P/08S	11,9	5,9	8	-	-	-	-	8	250	1000	1e ⁰⁷	3e ⁰⁷	10	4	ABS	ABS
CTC006 CTC011	CTC006S-00P/04S	11,9	6,5	4	-	-	-	-	4	250	1000	1e ⁰⁷	3e ⁰⁷	10	4	ABS	ABS
	CTC006S-00P/06S	11,9	6,5	6	-	-	-	-	6	250	1000	1e ⁰⁷	3e ⁰⁷	10	4	ABS	ABS
	CTC006S-00P/08S	11,9	6,5	8	-	-	-	-	8	250	1000	1e ⁰⁷	3e ⁰⁷	10	4	ABS	ABS
CTC012 CTC015	CTC011S-00P/06S	18,2	11	6	-	-	-	-	6	250	1000	1e ⁰⁷	3e ⁰⁷	10	4	ABS	ABS
	CTC012S-00P/06S	18,2	12,5	-	6	-	-	-	6	250	1000	1e ⁰⁷	3e ⁰⁷	10	4	ABS	ABS
	CTC012S-00P/12S	19,5	12,5	12	-	-	-	-	12	250	1000	1e ⁰⁷	3e ⁰⁷	10	4	ABS	ABS
CTC022 CTC025	CTC012S-00P/18S	23,5	12,5	18	-	-	-	-	18	250	1000	1e ⁰⁷	3e ⁰⁷	10	4	ABS	ABS
	CTC015S-00P/24S	39,7	15,5	24	-	-	-	-	24	250	1000	1e ⁰⁷	3e ⁰⁷	10	4	ABS	ABS
	CTC022S-03P/00S	19	22	-	-	3	-	-	3	250	1000	4e ⁰⁷	15e ⁰⁷	10	4	ABS	Metal
	CTC022S-01P/02S	19	22	2	-	1	-	-	3	250	1000	4e ⁰⁷	15e ⁰⁷	10	4	ABS	Metal
	CTC022S-02P/02S	19	22	2	2	-	-	-	4	250	1000	4e ⁰⁷	15e ⁰⁷	10	4	ABS	Metal
	CTC022S-00P/06S	19	22	6	-	-	-	-	6	250	1000	4e ⁰⁷	15e ⁰⁷	10	4	ABS	Metal
	CTC022S-03P/00S	26	22	-	-	3	-	-	3	250	1000	4e ⁰⁷	15e ⁰⁷	10	4	ABS	Metal
	CTC022S-02P/02S	26	22	2	-	2	-	-	4	250	1000	4e ⁰⁷	15e ⁰⁷	10	4	ABS	Metal
	CTC022S-03P/06S	26	22	6	3	-	-	-	9	250	1000	4e ⁰⁷	15e ⁰⁷	10	4	ABS	Metal
	CTC022S-00P/12S	26	22	12	-	-	-	-	12	250	1000	4e ⁰⁷	15e ⁰⁷	10	4	ABS	Metal
	CTC022S-02P/00S	33	22	-	-	-	-	2	2	250	1000	4e ⁰⁷	15e ⁰⁷	10	4	ABS	Metal
	CTC022S-04P/02S	33	22	2	-	4	-	-	6	250	1000	4e ⁰⁷	15e ⁰⁷	10	4	ABS	Metal
	CTC022S-03P/06S	33	22	6	-	3	-	-	9	250	1000	4e ⁰⁷	15e ⁰⁷	10	4	ABS	Metal
	CTC022S-06P/06S	33	22	6	6	-	-	-	12	250	1000	4e ⁰⁷	15e ⁰⁷	10	4	ABS	Metal
	CTC022S-00P/18S	33	22	18	-	-	-	-	18	250	1000	4e ⁰⁷	15e ⁰⁷	10	4	ABS	Metal
	CTC022S-03P/00S	43,6	22	-	-	-	-	3	3	250	1000	2e ⁰⁷	10e ⁰⁷	10	4	ABS	Metal
	CTC022S-05P/00S	43,6	22	-	-	5	-	-	5	250	1000	2e ⁰⁷	10e ⁰⁷	10	4	ABS	Metal
	CTC022S-04P/04S	43,6	22	4	-	4	-	-	8	250	1000	2e ⁰⁷	10e ⁰⁷	10	4	ABS	Metal
	CTC022S-02P/06S	43,6	22	6	-	-	-	2	8	250	1000	2e ⁰⁷	10e ⁰⁷	10	4	ABS	Metal
	CTC022S-05P/08S	43,6	22	8	-	3	2	-	13	250	1000	2e ⁰⁷	10e ⁰⁷	10	4	ABS	Metal
CTC022S-08P/08S	43,6	22	8	8	-	-	-	16	250	1000	2e ⁰⁷	10e ⁰⁷	10	4	ABS	Metal	
CTC022S-06P/12S	43,6	22	12	6	-	-	-	18	250	1000	2e ⁰⁷	10e ⁰⁷	10	4	ABS	Metal	
CTC022S-03P/18S	43,6	22	18	3	-	-	-	21	250	1000	2e ⁰⁷	10e ⁰⁷	10	4	ABS	Metal	
CTC022S-00P/24S	43,6	22	24	-	-	-	-	24	250	1000	2e ⁰⁷	10e ⁰⁷	10	4	ABS	Metal	
CTC022S-00P/36S	57,3	22	36	-	-	-	-	36	250	1000	2e ⁰⁷	10e ⁰⁷	10	4	ABS	Metal	
CTC025S-00P/56S	85,7	25	56	-	-	-	-	56	250	1000	2e ⁰⁷	10e ⁰⁷	10	4	ABS	Metal	

SPECIFICATION

Specification	OD < 15,5mm		OD=15,5mm		OD > 15,5mm	
	Power	Signal	Power	Signal	Power	Signal
Rated Voltage	0~240 VAC/VDC	0~240 VAC/VDC	0~240 VAC/VDC	0~240 VAC/VDC	0~240 VAC/VDC	0~240 VAC/VDC
Insulation Resistance	≥600MΩ/500VDC		≥600MΩ/500VDC		≥600MΩ/500VDC	
Insulation Strength	500VAC@50Hz, 60s					
Lead Wires	AWG32#Teflon		AWG30#Teflon		AWG28#Teflon	
Lead Length	Standard 300mm (adjustable)					
Working Temperature	-30°C to 80°C					
Operating Humidity	0 ~ 85% RH					
Torque	0,05 Nm; +0,02 Nm/Grings		0,05 Nm; +0,02 Nm/Grings		0,05 Nm; +0,01 Nm/Grings	
Protection Grade	IP51					

RATING DATA

- CTC series slip rings are miniature with OD 12,5mm are small and compact with OD 22mm, with capsule style.
- Special designed for CCTV or small rotating system, OD 22mm and special fit for middle/small rotating system of transmitting low controlling signal.

- Circuits combination is available (such as video, control, sensor, power, Ethernet and so on)
- Lower torque low contact wear rates
- Support video, control, sensor, power, Ethernet signals

PART NUMBER

CTC 012S - xxP/yyS - 00000 - XXXXX

1 2 3 4 5 6 7 8 9

- 1 Inner Dia
- 2 Quality Level
S = Standard
I = Industrial
- 3 Number of power wires
- 4 Number of signal wires
- 5 Flange
00
01
..07
- 6 Flange Position
O = No Flange
R = Rotor
I = Interior
S = Stator
- 7 Rotor cable length
0 = 300mm
1 = 600mm
2 = 1200mm
X = Custom
- 8 Stator cable length
0 = 300mm
1 = 600mm
2 = 1200mm
X = Custom
- 9 Special Options
01CAN = CanOpen
01ECT= Ethercat
01PRO = Profibus
01ETH = Giga Ethernet
IP65 = IP65
IP68 = IP68



IP51
[standard]



Voltage
240 VDC/VAC



Current
1A to 15A



Working Temperature
-30°C to 80°C



Max speed
1000 RPM

FLANGES

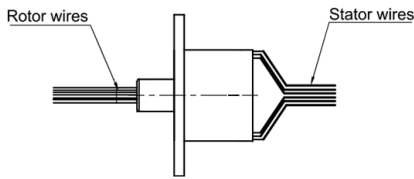

R

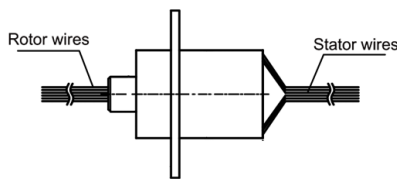

I

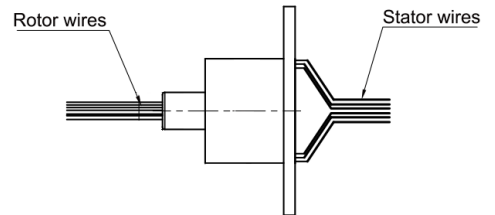

S

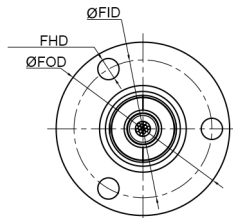

FLANGE	FOD	FID	ØFHD
00	44	35	3xØ5,4
01	44	35	3xØ5,4
02	44	35	3xØ5,4
03	29	39	3xØ3,5
04	27	32	3xØ2,8
05	-	-	-
06	35	44	3xØ5,4
07	-	-	-

	FLANGES OPTIONS																					
	No (00)	22,5x17,5 (01)			24x18 (02)			29x22 (03)			32x25 (04)			32x27 (05)			39x29 (06)			44x35 (07)		
		R	I	S	R	I	S	R	I	S	R	I	S	R	I	S	R	I	S			
CTC005-4	■	-	-	-	-	-	-	-	-	-	-	-	-	-	-	-	-	-	-	-		
CTC005-8	■	-	-	-	-	-	-	-	-	-	-	-	-	-	-	-	-	-	-	-		
CTC006-8	■	-	-	-	-	-	-	-	-	-	-	-	-	-	-	-	-	-	-	-		
CTC011-6	■	-	-	-	-	-	-	-	-	-	-	-	-	-	-	-	-	-	-	-		
CTC012-6	●	●	-	-	■	●	●	●	-	-	-	-	-	-	-	-	-	-	-	-		
CTC012-12	●	-	-	-	-	■	-	-	-	-	-	-	-	-	-	-	-	-	-	-		
CTC012-18	●	-	-	-	-	-	-	-	-	-	-	-	-	-	-	-	-	-	-	-		
CTC015-24	●	-	-	-	-	-	-	-	-	■	-	-	-	-	-	-	-	-	-	-		
CTC-022-6	●	-	-	-	-	-	-	-	-	-	-	-	●	-	-	●	-	●	■	●		
CTC022-12	●	-	-	-	-	-	-	-	-	-	-	-	●	-	-	●	-	●	■	●		
CTC022-18	-	-	-	-	-	-	-	-	-	-	-	-	-	-	-	-	-	-	■	-		
CTC022-24	-	-	-	-	-	-	-	-	-	-	-	-	-	-	-	-	-	-	■	-		
CTC022-36	-	-	-	-	-	-	-	-	-	-	-	-	-	-	-	-	-	-	■	-		
CTC025-56	-	-	-	-	-	-	-	-	-	-	-	-	-	-	-	-	-	-	■	-		

■ STANDARD FEATURE ● OPTION - OPTION NOT AVAILABLE

In accordance with our policy of continual product improvement, A2V reserves the right to amend the specification of these products without prior notification